

Drawing No. W/FZ/304-311

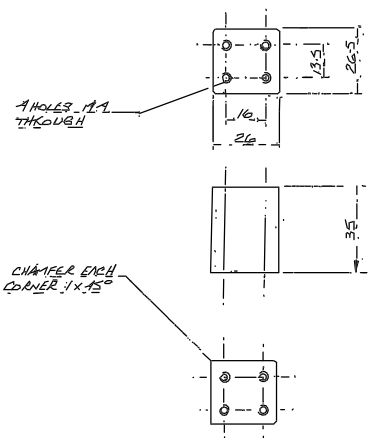

4 FILLAR		
MATERIAL	SCALE	TOLERANCES
AL. ALLOY	1:1	X ± 0.2
FINISH	NO REQ. PER UNIT	X.X
BL. ANODISE	3	X.XX
D.A. No.	DRAWING No.	
V/FZ/300	R.G.O. W/FZ/304	

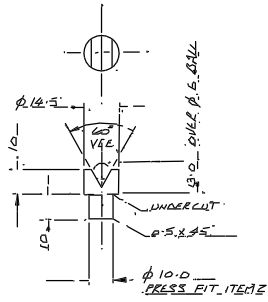

5 KINEMATIC MOUNT 'A'		
MATERIAL	SCALE	TOLERANCES
EN 57	1:1	X ± 0.2
FINISH	NO REQ. PER UNIT	X.X
		X.XX
D.A. No.	DRAWING No.	
V/FZ/300	R.G.O. W/FZ/305	

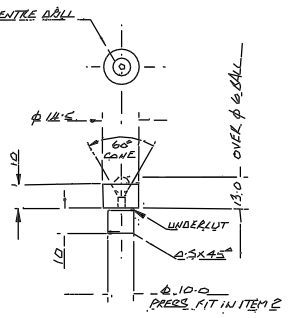

6 KINEMATIC MOUNT 'B'		
MATERIAL	SCALE	TOLERANCES
EN 57	1:1	X ± 0.2
FINISH	NO REQ. PER UNIT	X.X
		X.XX
D.A. No.	DRAWING No.	
V/FZ/300	R.G.O. W/FZ/306	

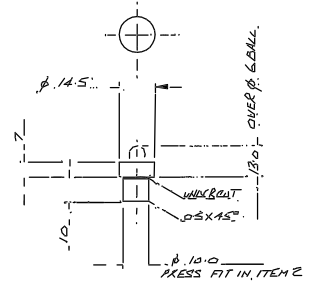

7 KINEMATIC MOUNT 'C'		
MATERIAL	SCALE	TOLERANCES
EN 57	1:1	X ± 0.2
FINISH	NO REQ. PER UNIT	X.X
		X.XX
D.A. No.	DRAWING No.	
V/FZ/300	R.G.O. W/FZ/307	

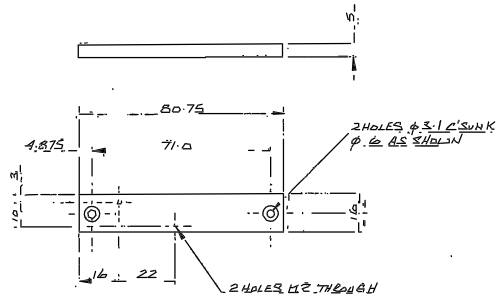

8 SWITCH PLATE		
MATERIAL	SCALE	TOLERANCES
AL. ALLOY	1:1	X ± 0.2
FINISH	NO REQ. PER UNIT	X.X
BL. ANODISE	1	X.XX
D.A. No.	DRAWING No.	
V/FZ/300	R.G.O. W/FZ/308	

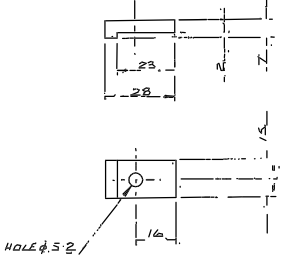

9 CLAMP		
MATERIAL	SCALE	TOLERANCES
EN 57	1:1	X ± 0.2
FINISH	NO REQ. PER UNIT	X.X
BL. NICKEL	4	X.XX
D.A. No.	DRAWING No.	
V/FZ/300	R.G.O. W/FZ/309	

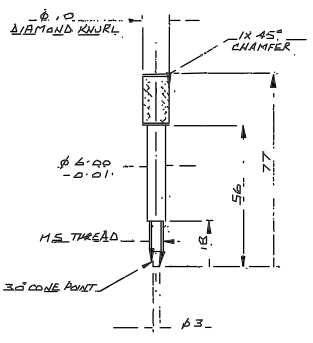

10 LOCKING PIN		
MATERIAL	SCALE	TOLERANCES
STAINLESS STEEL	1:1	X ± 0.2
FINISH	NO REQ. PER UNIT	X.X
		X.XX
D.A. No.	DRAWING No.	
V/FZ/300	R.G.O. W/FZ/310	

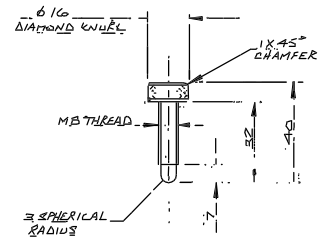

11 SCREW		
MATERIAL	SCALE	TOLERANCES
EN 57	1:1	X ± 0.2
FINISH	NO REQ. PER UNIT	X.X
		X.XX
D.A. No.	DRAWING No.	
V/FZ/300	R.G.O. W/FZ/311	